

SILICONE RUBBER HEATERS

Lead Wire Styles

Teflon or Silicone Lead Wires

The leads are set between layers of silicone and a small patch is inserted at the exit point to provide extra support and protection. The result is a small bump where the wires are attached. To prevent this, a small external tab can be attached.

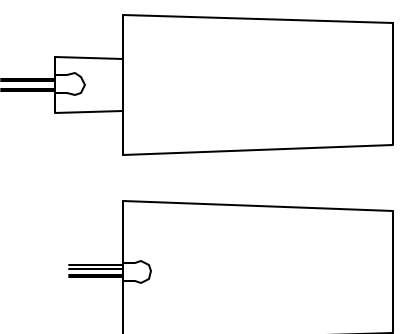

SJO Power Cables

Siliflex heaters can be made with power cables that exit from a silicone transitions box attached to the heater. Proper electrical plugs are available with the power cables.

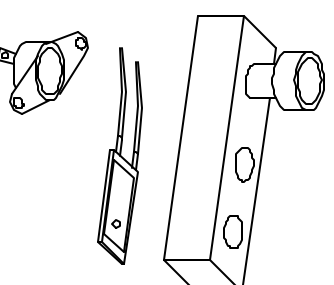
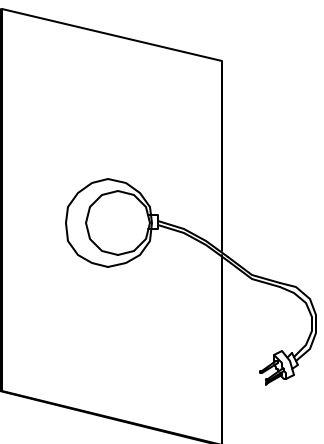

Siliflex heaters can accommodate pre-set or adjustable thermostats, thermal cutoffs and external "J" type thermocouples. Each has a specific temperature range and maximum amperage capability; the factory should be consulted for their availability.