



Thermal Manufacturing Solutions

Section G

Thermocouples And RTD Accessories

Connection Heads	G-1
Terminal Blocks And Bayonet Adaptors	G-3
Plugs And Jacks	G-4
Strippannels	G-6

THERMOCOUPLE AND RTD ACCESSORIES

DIE CAST ALUMINUM

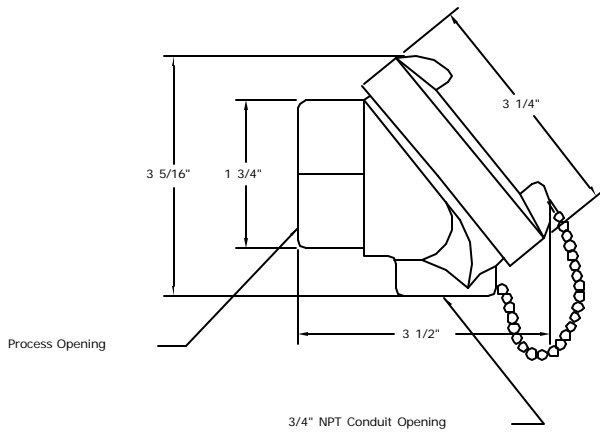

CAST IRON

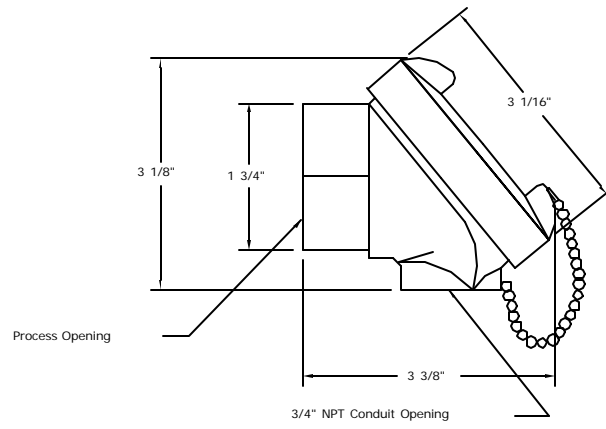

EXPLOSION PROOF

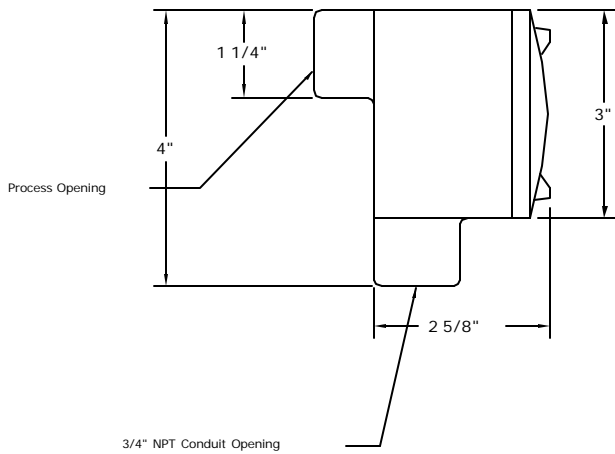

GREY PIGMENTED DELRIN CAP

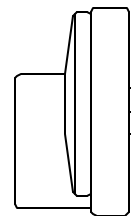

THERMOCOUPLE AND RTD ACCESSORIES

SCREW COVER HEADS								
HEAD AND CAP MATERIAL	PROCESS OPENING	HEAD AND CAP WITHOUT BLOCK	COMPLETE HEAD AND BLOCK ASSEMBLIES					
			SINGLE	DUPLEX	TRIPLEX			
					2-TERM	3-TERM	4-TERM	6-TERM
DIE CAST ALUMINUM	1/8" NPT	301	311	321	331-2	331-3	331-4	331-6
DIE CAST ALUMINUM	1/4" NPT	302	312	322	332-2	332-3	332-4	332-6
DIE CAST ALUMINUM	3/8" NPT	303	313	323	333-2	333-3	333-4	333-6
DIE CAST ALUMINUM	1/2" NPT	304	314	324	334-2	334-3	334-4	334-6
DIE CAST ALUMINUM	3/4" NPT	305	315	325	335-2	335-3	335-4	335-6
DIE CAST ALUMINUM	1" NPT	306	316	326	336-2	336-3	336-4	336-6
CAST IRON	1/2" NPT	307	317	327	337-2	337-3	337-4	337-6
CAST IRON	3/4" NPT	308	318	328	338-2	338-3	338-4	338-6
CAST IRON	1" NPT	309	319	329	339-2	339-3	339-4	339-6
CAST IRON	1" NPT	309	319	329	339-2	339-3	339-4	339-6
EXPLOSION PROOF	1/2" NPT	601	611	621	337-2	337-3	337-4	337-6
EXPLOSION PROOF	3/4" NPT	602	612	622	338-2	338-3	338-4	338-6
316L SS	1/2" NPT	904	914	924	934-2	934-3	934-4	934-6
316L SS	3/4" NPT	905	915	925	935-2	935-3	935-4	935-6
HEAD AND CAP MATERIAL	PROCESS OPENING	NO TERMINALS	NUMBER OF SELF-CONTAINED TERMINALS					
			2	3	6			
GREY PIGMENTED DELRIN	1/2" NPT	390	392	393	396			
WHITE POLYPROPYLENE	1/2" NPT	480	482	483	484			

SCREW COVER HEAD OPTIONS	
CODE	DESCRIPTION
B	INTERNAL GROUND SCREW
R	RUBBER GASKET
W	PROTECTIVE WHITE EPOXY COATING

EXAMPLE PART NUMBER: 331-2W
 DIE CAST ALUMINUM SCREW COVER
 WITH 2 TERMINAL TRIPLEX TERMINAL
 BLOCK AND PROTECTIVE WHITE
 EPOXY COATING

THERMOCOUPLE AND RTD ACCESSORIES

CERAMIC TERMINAL BLOCKS		
TERMINAL BLOCK TYPE	NUMBER OF TERMINALS	PART NUMBER
SINGLE	2	341
DUPLEX	4	342
TRIPLEX	2	343-2
TRIPLEX	3	343-3
TRIPLEX	4	343-4
TRIPLEX	6	343-6

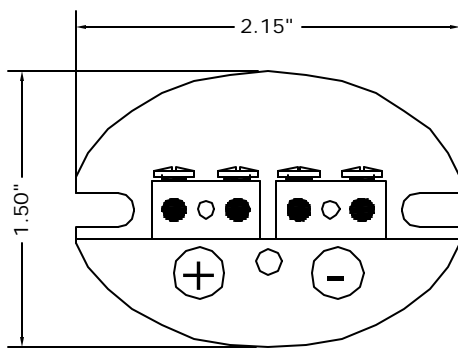

341 BLOCK

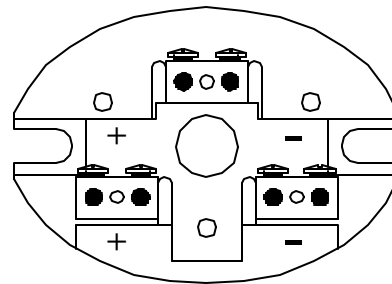

343-3 BLOCK

BAYONET ADAPTORS			
MATERIAL	LENGTH	THREAD	PART NUMBER
STEEL, ZINC PLATING	7/8"	1/8-27 NPT	A-01
STEEL, ZINC PLATING	7/8"	3/8-NF-2	A-02
STEEL, ZINC PLATING	1 3/8"	1/8-27 NPT	A-03
STEEL, ZINC PLATING	1 3/8"	3/8-NF-2	A-04

* OTHER MATERIALS, LENGTHS AND THREAD SIZES AVAILABLE

THERMOCOUPLE AND RTD ACCESSORIES

STANDARD PLUG, 2 PIN

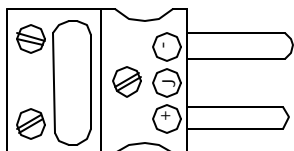

STANDARD JACK, 2 PIN

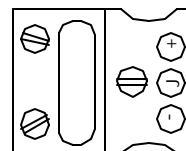

MINIATURE PLUG, 2 PIN

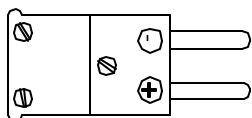

MINIATURE JACK, 2 PIN

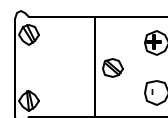

STANDARD PLUG, 3 PIN

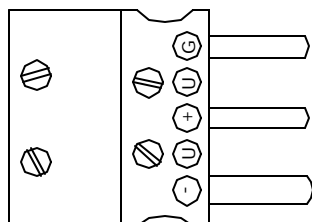

STANDARD JACK, 3 PIN

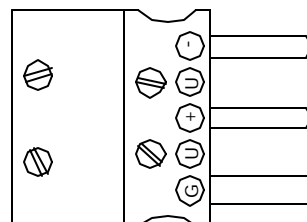

MINIATURE PLUG, 3 PIN

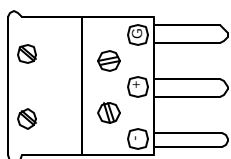

MINIATURE JACK, 3 PIN

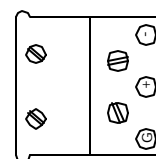

CABLE CLAMP

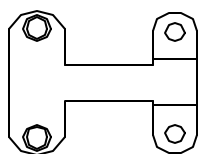

NEOPRENE BOOT

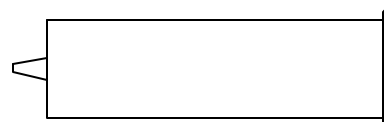

THERMOCOUPLE AND RTD ACCESSORIES

THERMOCOUPLE AND RTD CONNECTORS			
TYPE	CALIBRATION	STANDARD SIZE PART NUMBER	MINIATURE PART NUMBER
PLUG, 2 PIN	E	A2000E ¹	AM2000E ²
PLUG, 2 PIN	J	A2000J ¹	AM2000J ²
PLUG, 2 PIN	K	A2000K ^{1,4}	AM2000K ²
PLUG, 2 PIN	N	A2000N ¹	AM2000N ²
PLUG, 2 PIN	R	A2000R ¹	AM2000R ²
PLUG, 2 PIN	T	A2000T ¹	AM2000T ²
PLUG, 2 PIN	RTD	A2000RTD ¹	AM2000RTD ²
PLUG, 3 PIN	E	A8000E ³	AM8000E
PLUG, 3 PIN	J	A8000J ³	AM8000J
PLUG, 3 PIN	K	A8000K ³	AM8000K
PLUG, 3 PIN	R	A8000R ³	AM8000R
PLUG, 3 PIN	T	A8000T ³	AM8000T
PLUG, 3 PIN	RTD	A8000RTD ³	AM8000RTD
JACK, 2 PIN	E	A1000E ²	AM1000E
JACK, 2 PIN	J	A1000J ²	AM1000J ²
JACK, 2 PIN	K	A1000K ^{2,4}	AM1000K ²
JACK, 2 PIN	N	A1000N ²	AM1000N
JACK, 2 PIN	R	A1000R ²	AM1000R
JACK, 2 PIN	T	A1000T ²	AM1000T
JACK, 2 PIN	RTD	A1000RTD ²	AM1000RTD
JACK, 3 PIN	E	A9000E	AM9000E
JACK, 3 PIN	J	A9000J	AM9000J
JACK, 3 PIN	K	A9000K	AM9000K
JACK, 3 PIN	R	A9000R	AM9000R
JACK, 3 PIN	T	A9000T	AM9000T
JACK, 3 PIN	RTD	A9000RTD	AM9000RTD
CABLE CLAMP	ALL	A4000	A4000M
NEOPRENE BOOT	FOR 2-PIN CONNECTORS ONLY	A420	N/A

1 = ALSO AVAILABLE IN SOLID PIN, JAB-IN AND HIGH TEMP

2 = ALSO AVAILABLE IN HIGH TEMP

3. = ALSO AVAILABLE IN SOLID PIN

4. = ALSO AVAILABLE IN 8 GAUGE JAB-IN

STRIPANLES, 2 POLE

COMPLETE ORDER NUMBER

1 - 2 - 3

1. NUMBER OF CIRCUITS		
CIRCUITS	A LENGTH	CODE
2 CIRCUIT	1.50"	A1032-2
3 CIRCUIT	2.25"	A1032-3
4 CIRCUIT	3.0"	A1032-4
5 CIRCUIT	3.75"	A1032-5
6 CIRCUIT	4.50"	A1032-6
7 CIRCUIT	5.25"	A1032-7
8 CIRCUIT	6.0"	A1032-8
9 CIRCUIT	6.75"	A1032-9
10 CIRCUIT	7.50"	A1032-10
11 CIRCUIT	8.25"	A1032-11
12 CIRCUIT	9.0"	A1032-12

2. CALIBRATION	
CODE	
C	
E	
J	
K	
N	
R	
S	
T	
RTD	

3. OPTIONS	
CODE	DESCRIPTION
V	VERTICAL STRIPANEL
1132	ALL STRIPANELS ARE AVAILABLE IN HIGH TEMP. SUBSTITUTE A1032 WITH A1132

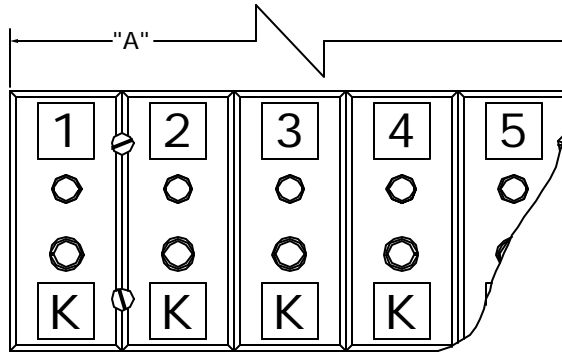

JACK PANEL, 2 POLE

COMPLETE ORDER NUMBER

1 - 2

1. NUMBER OF CIRCUITS	
TYPE	CODE
STANDARD	A1031
HI-TEMP	A1131

2. CALIBRATION	
CODE	
C	
E	
J	
K	
N	
R	
S	
T	
RTD	

