

PIPE CLAMP ADAPTORS

Pipe clamps are used in conjunction with Acrolab's A100, A145, A190, A500 and A510 series bayonet style thermocouples. They are designed for temperature measurement on the outside of a pipe.

Pipe clamps are an economical and efficient design that requires no machining or tapping to mount them. Custom diameters and bayonet adaptor locations are also available.

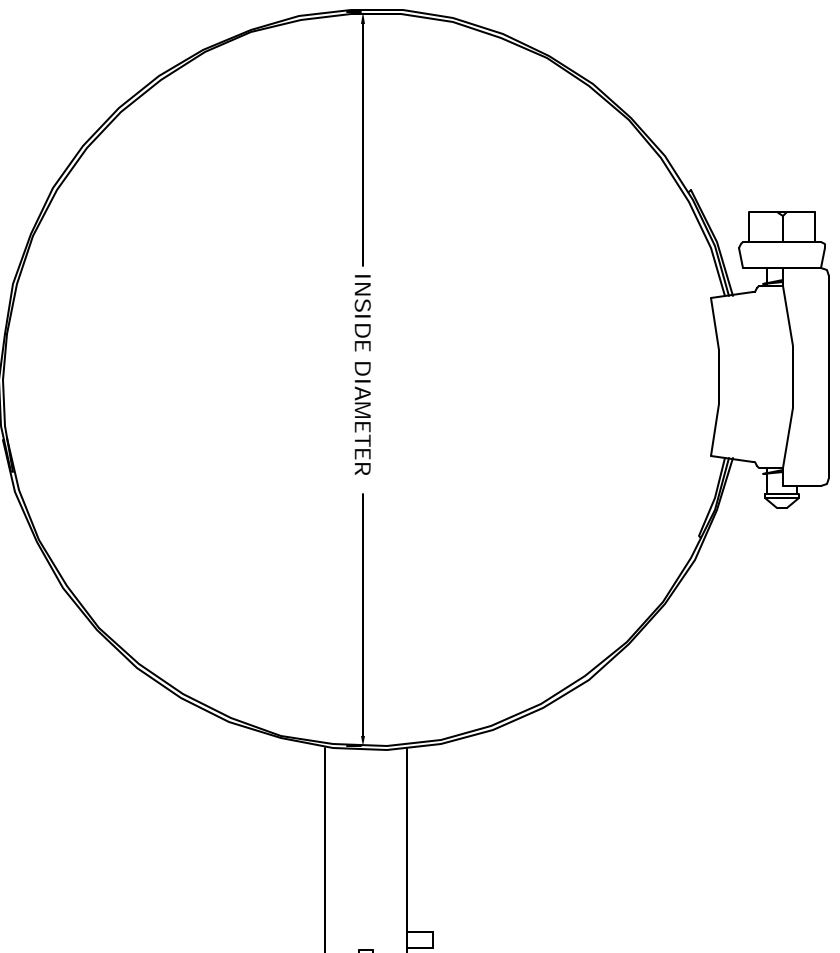

PART NUMBER	FITS OUTSIDE DIAMETER
BA-20	1/2" TO 7/8"
BA-21	7/8" TO 1 1/4"
BA-22	1 1/4" TO 2"
BA-23	2" TO 2 1/2"
BA-24	2 1/4" TO 3 1/4"
BA-25	3 1/4" TO 4 1/4"
BA-26	4 1/4" TO 5"